

PREPARED FOR  
LAURA RODRIGUEZ  
KEEFE REAL ESTATE  
LAKE GENEVA WI.

# PLAT OF SURVEY

- OF -

LOT 39 WOODSTONE SUBDIVISION, A SUBDIVISION LOCATED IN THE NORTHWEST 1/4 OF THE  
NORTHEAST 1/4 AND PART OF THE SOUTHWEST 1/4 AND SOUTHEAST 1/4 OF THE NORTHEAST 1/4 OF  
SECTION 16, TOWN 1 NORTH, RANGE 17 EAST OF THE FOURTH PRINCIPAL MERIDIAN, LYING AND  
BEING IN THE TOWN OF LINN, COUNTY OF WALWORTH, AND STATE OF WISCONSIN.

PATHFINDER SURVEYING INC.  
(formerly)  
J.K. SURVEYING INC.  
P.O BOX 322  
LAKE GENEVA, WI. 53147  
WWW.PATHFINDERSURVEYING.NET  
262-248-8303

Lot 39  
0.73 acres  
31856.84 sq ft

SEPTIC LIDS

EXISTING HOUSE

SCREEN PORCH

asphalt

C.L. WOODSTONE LANE  
(66' WIDE ROAD)

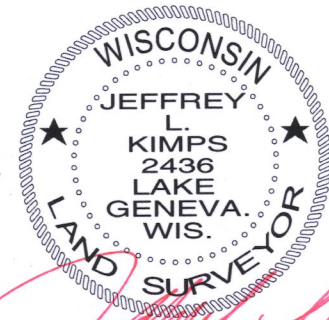

JEFFREY L. KIMPS S-2436  
Wisconsin Professional Land Surveyor  
(original if signed in red)

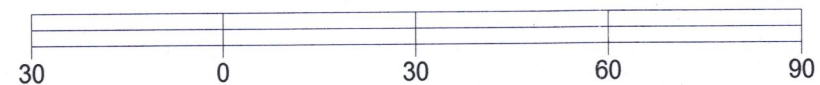

BASIS OF BEARING OF THIS PLAT: THE SUBDIVISION PLAT OF RECORD.

"I hereby certify that I have surveyed the above described property and that  
the above map, to the best of my knowledge and belief, is a true representation  
thereof and shows the size and location of all visible structures, apparent  
easements and encroachments if any."  
This survey is made for the present owners of the property, and those who  
purchase, mortgage, or guarantee the title thereto, within one year from  
the date hereof.

DATED THIS 11TH DAY OF MAY, 2017.

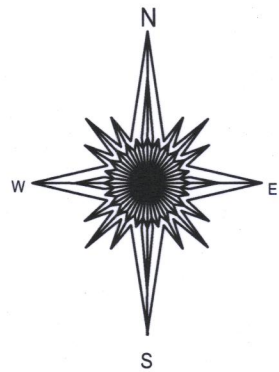

- ( ) = recorded as
- = found iron bar
- = found iron pipe
- = set iron pipe
- = set iron bar

SCALE 1" = 30'

JOB # 04-623ud2017

IWO-39

117-4032